

REGAL WALL

INSTALLATION STEPS & GUIDELINES

(DENSEPACK SYSTEM FOR INSULATING NEW CONSTRUCTION OPEN FRAMED ASSEMBLIES)

QUICK REVIEW OF STEPS

1) Measure the correct length of the Insulweb cloth for the wall, and cut with a razor type knife. Allow additional 6" overlap at each end.

2) Start in one corner and staple the Insulweb cloth to the top plate approximately every 6-9 inches, keeping the cloth even with the top of the top plate.

3) Staple to bottom plate while stretching tight. Start @ bottom middle and work to each end.

4) Staple window/door & end studs and trim excess cloth.

5) Attach with staples all cloth areas not in direct contact with vertical mid-studs.

NOTE: Return and add additional staples around perimeter to complete stapling. There should be approx. 3" between each staple.

6) Apply adhesive with a 3" maximum wide paint roller, sponge, brush or any other suitable means. Allow to dry before blowing insulation.

7) Finish trimming, electrical boxes, windows, doors, etc.

8) Fill each cavity from **bottom up to the top**.

Note: An installed density of 3 lbs. per cu. ft. min. is necessary to prevent settling in cavity. The bag's sidewall coverage chart numbers are based on 3 lbs. per cu.ft. Most installers will blow approx. 3.5 lbs. per cu.ft. plus.

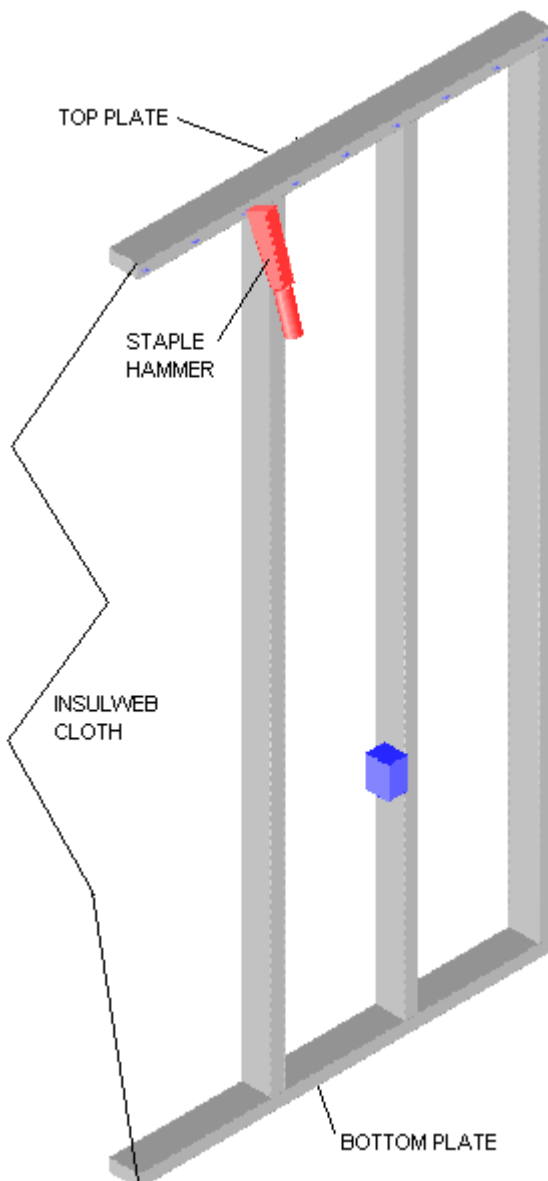

COMPARE THESE STEPS WITH BELOW DIAGRAM

- A :** Starting at top of either end (1) staple Insulweb to top plate spacing @ 6-9”.
- B :** Stretch cloth down towards bottom plate middle (2) until it is tight and begin stapling along bottom plate moving to each end (4 & 5).
- C :** Secure fabric with staples on end studs (6), trim excess overlap.
- D :** Staple around perimeter of doors and/or windows (3), trim excess.
- E :** Insure fabric is making contact against mid-vertical studs (7). If not, apply staples where necessary to draw fabric against stud(s).
- F :** Trim electrical boxes by cutting on 3 sides (8). Do not cut 4th side (side opposite wall stud). This method creates a “flap”. Fold flap inward, along side of box.
- G :** Finish completing perimeter stapling at 3” spacing.
- H :** See recommended *Blowing Technique* on page 4.

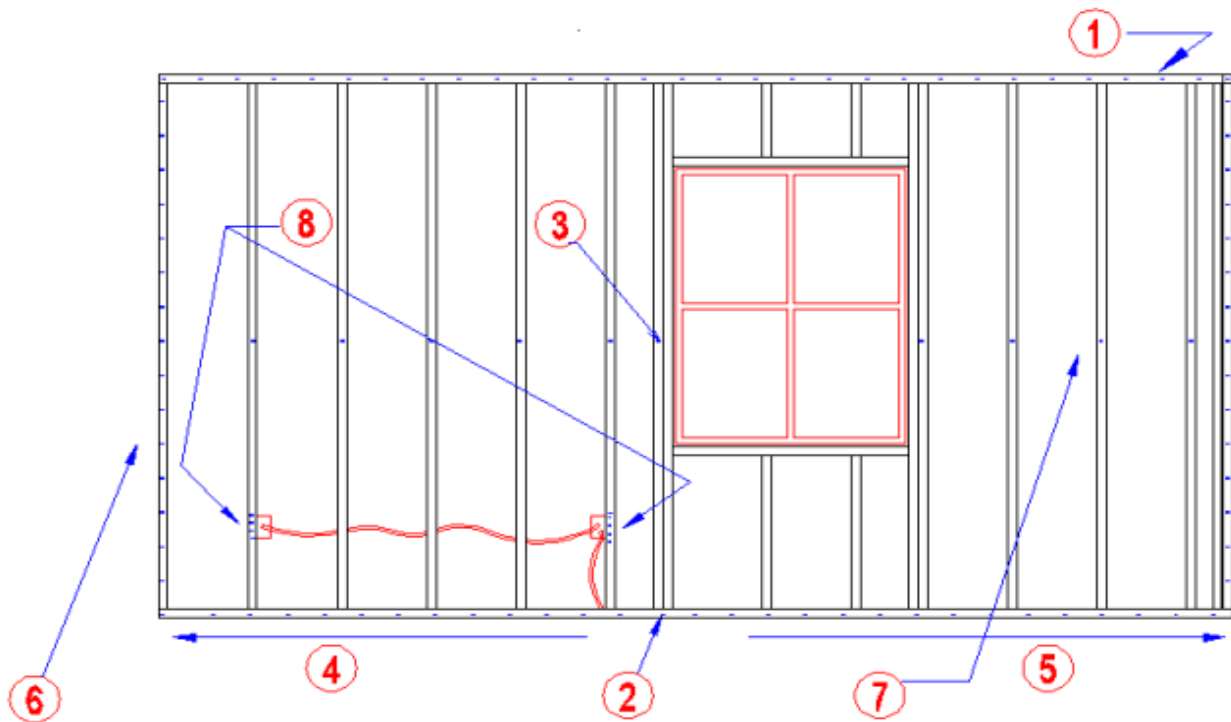

APPLYING REGAL WALL GLUE

3 inch wide paint roller
on an extension pole.



paint tray

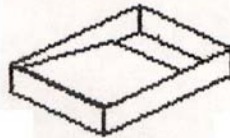

Roll on Regal Wall warm weather or cold weather adhesive over fabric to each stud face. Use a 3-inch wide *maximum* paint roller to cover. Use a handle extension for easy reach. A paint tray (recommend plastic) can be used for the adhesive. 1-coat is sufficient. Allow adhesive to dry before installing cellulose insulation. Drying time dependant upon room temperature.

INSTALLING CELLULOSE INSULATION INTO REGAL WALL CAVITY

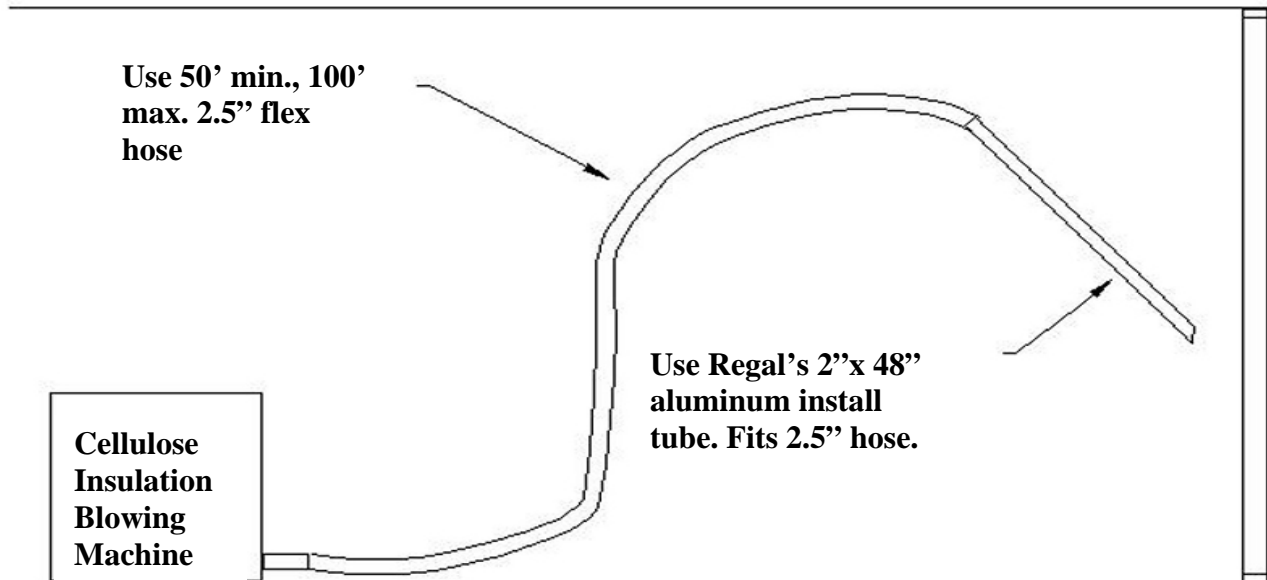

*** RECOMMENDED BLOWING TECHNIQUE ***

- a. There will need to be one person feeding bags of insulation into blowing machine and one person operating the delivery hose. Figure your wall area in sq.ft. and compare to sidewall coverage chart on each bag for determining approximate number of bags needed.
- b. Using a box knife or similar, slice a 4-6" vertical opening in each cavity at approx. 4' above floor level. These are for allowing insertion of the install tube into each cavity.
- c. Insert and position the install tube outlet just above the bottom of the cavity. Turn on machine and begin blowing insulation. Slowly move tube outlet side to side retracting at 6-12" levels as cavity is filling. This method provides for a consistent density to eliminate settling.
- d. Once insulation has risen 6-12" above insert opening invert tube and move outlet to top of cavity. Continue blowing, moving tube outlet side to side retracting towards insert opening.
- e. Once you have reached insert opening steady tube outlet for 2-4 seconds adding additional insulation into that central area. Note: when filled machine is operating and insulation stops flowing thru hose this means area is sufficiently filled with insulation.
- f. Turn off machine using remote control, withdraw install tube and insert into neighboring cavity and repeat procedures. It is not necessary to "patch" repair the insert opening.
- g. Use 50' of flex hose min.: Important in order to achieve the most coverage from each bag.
- h. Watch for "pillowing". Don't allow fabric to exceed more than 1/2" past vertical studs face.
- i. After blowing sidewalls go back and recheck cavities. You may find a few cavities that have a darker shaded area (light on density), generally in the upper portion of the cavity(s). Cut a 2-3" slice and reinstall tube and add additional insulation until shaded area disappears or until area will take no more insulation.

******* REGAL WALL ACCESSORIES LIST *******

ITEMS NEEDED FOR CORRECT REGAL WALL INSTALLATION

(EXCLUDING CELLULOSE INSULATION....Note: any brand of cellulose insulation will work in this system)

1. **INSULWEB** by the Roll4 ft. x 375 ft.....\$ 52.2610 ft. x 375 ft....\$ 130.24
.....8 ft. x 375 ft..... \$ 104.23 12 ft. x 375 ft....\$ 156.33
.....9 ft. x 375 ft..... \$ 117.269 ft. x 750 ft.... \$ 277.35 **
..... 4 ft. x 500 ft... \$ 188.13 **
** (fold-over style Insulweb)

NOTE : 4- 8 ft. rolls and 4- 9 ft. fold-over can be UPS'd. 9, 10 and 12 ft. rolls shipped common carrier only. Shipping charges additional. No freight charge when shipped with trucked cellulose order.

2. **WARM WEATHER GLUE**..(LATEX FORMULA...use above 32 F)....\$ 22.44 per 1-gal. container.

NOTE: 1 gal.. covers up to125' total length of an 8 ft. x 16 o.c. studded wall assembly. (1 coat sufficient).

3. **COLD WEATHER GLUE**.....(SOLVENT FORMULA).....\$ 107.50 per 5-gal. container.
.....\$ 555.10 per 55-gal container.

NOTE: Paint rollers and throwaway pans available from your local paint and hardware supplier.

4. **INSTALLATION NOZZLE**...4 ft. x 2" Aluminum "Tubing" Nozzle...**A MUST!**.....\$ 16.00 ea.
2.5" x 1" o.d. reducer nozzle.....\$ 8.95 ea.

5. **STAPLE GUN & STAPLES**....

Staple Gun (hand operated) ...\$ 29.99 ea. Air Stapler.....\$ 323.75 ea.
Staples (20 boxes per case)....\$ 5.25 ea. box Air Staples....(10 boxes per case)....\$ 81.70 case

6. **OPTIONAL ITEMS**.....

- **DENSITY MEASURING INSTRUMENT** (determines correct wt. per cu. ft.)\$ 125.00 ea.
- **REGAL WALL ROLLER**...(to correct overblown cavities).....**VERY HELPFUL!**..... 55.00 ea.

NOTE:

- **TO ORDER** above items, call 800-848-9687....have credit card information available.
- **REGAL WALL Instructions** @ www.regalind.com ...in Technical Information Section.
- **For QUESTIONS** pertaining to Regal Wall....call Regal @ 800-848-9687 ext. 216.

SL-11-07